



### ● Applications

- Electric tools
- Electric toys
- Emergency lighting
- Electronic instruments
- Medical equipment
- Alarm and security systems
- Solar power systems
- Wind power systems
- Telecommunication equipments
- Uninterruptible power supplies

### ● Specifications

Nominal Voltage		12V
Rated Capacity (20 hour rate)		6Ah
Dimensions	Total Height	101±2mm(3.98 inches)
	Height	95±2mm(3.74 inches)
	Length	151±2mm(5.94 inches)
	Width	65 mm(2.13 inches)
Weight Approx		1.76kg(3.88lbs)± 4%

### ● Outer Dimensions (mm)

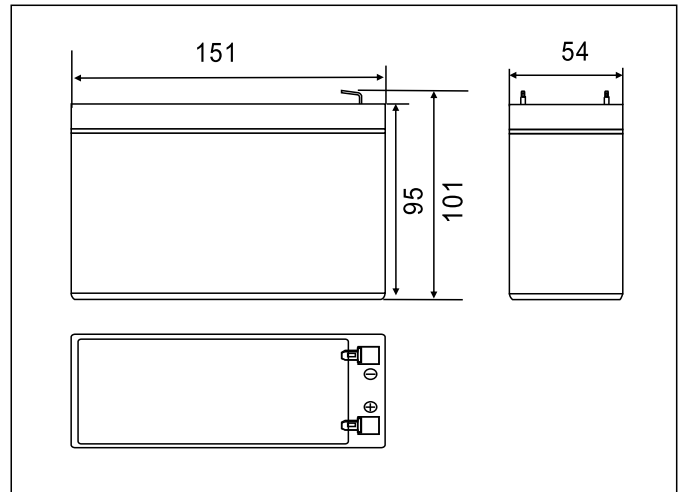

### ● Characteristics

Capacity 25°C(77°F)	20 hour rate(0.30A)	6.00 AH
	10 hour rate(0.57A)	5.70 AH
	5 hour rate(1.04A)	5.20AH
	1 hour rate(3.90 A)	3.90 AH
Internal Resistance	Full charged Battery at 25°C(77°F)	22m Ω
Capacity affected by Temperature (20hour rate)	40°C(104°F)	102%
	25°C(77°F)	100%
	0°C(32°F)	85%
	-15°C(5°F)	65%
Self-Discharge at 25°C(77°F)	Capacity after 3 month storage	91%
	Capacity after 6 month storage	82%
	Capacity after 12 month storage	64%
Charge (constant voltage)	Cycle	Initial Charging Current Less than 1.8 A Voltage 14.50-14.90V
	Float	Voltage 13.50-13.80V

### ● Terminal Type (mm)

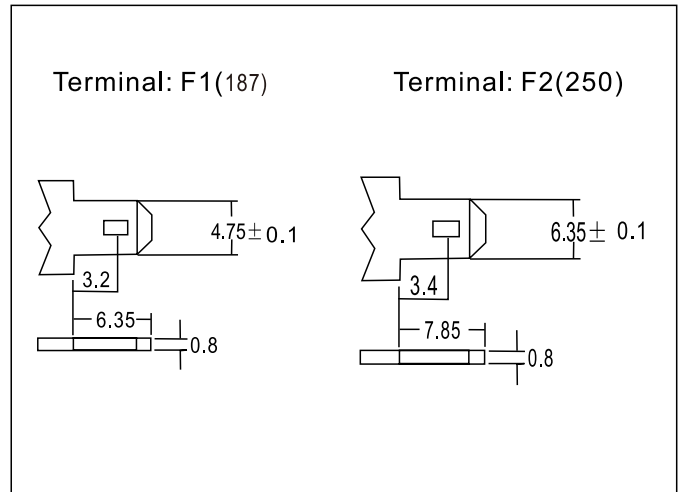

### Constant Current(AMP) and Constant Power(Watt) Characteristics at 25°C(77°F)

F.V/TIME	5min	10min	15min	30min	1h	2h	3h	4h	5h	10h	20h
9.60V	A	22.8	14.4	11.4	6.36	3.90	2.13	1.53	1.22	1.04	0.30
	w	254	162	130	72.9	45.2	24.9	18.2	14.6	12.4	3.65
9.90V	A	22.1	14.0	11.1	6.23	3.84	2.12	1.52	1.22	1.03	0.30
	w	247	158	127	71.4	44.5	24.8	18.1	14.5	12.3	3.64
10.2V	A	21.2	13.4	10.7	6.04	3.74	2.10	1.51	1.21	1.03	0.30
	w	237	151	122	69.2	43.4	24.6	17.9	14.4	12.3	3.62
10.5V	A	20.3	12.8	10.4	5.90	3.67	2.07	1.50	1.20	1.02	0.30
	w	226	145	118	67.6	42.5	24.2	17.8	14.3	12.2	3.60
10.8V	A	19.2	12.1	9.80	67.6	3.56	2.02	1.46	1.16	0.99	0.29
	w	214	136	112	5.68	41.2	23.6	13.9	13.9	11.8	3.53

### ● Discharge Characteristics(25°C)

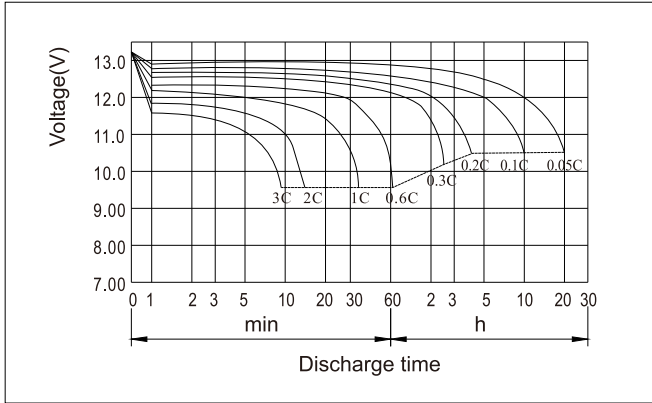

### ● Charging Characteristics(25°C)

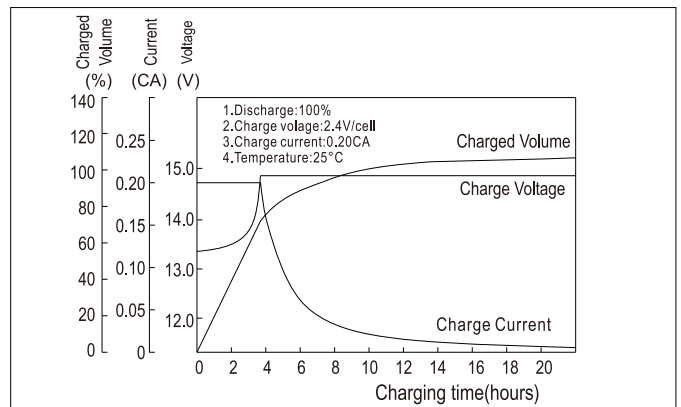

### ● Effect of Temperature on Capacity

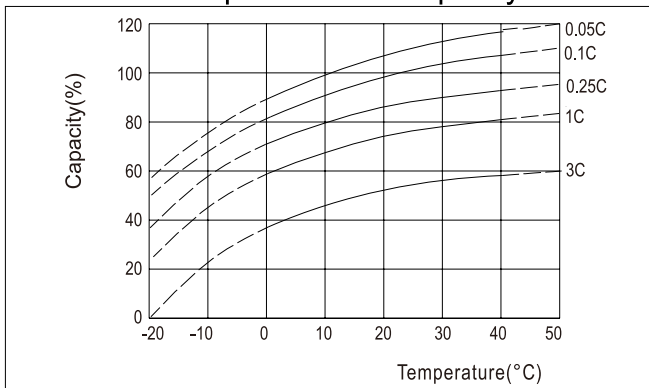

### ● Self-discharge Characteristics

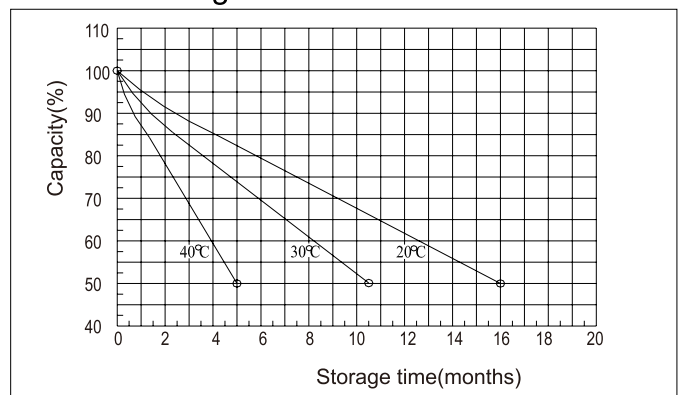

### ● The Relationship for Open Circuit Voltage and Residual Capacity (25°C)

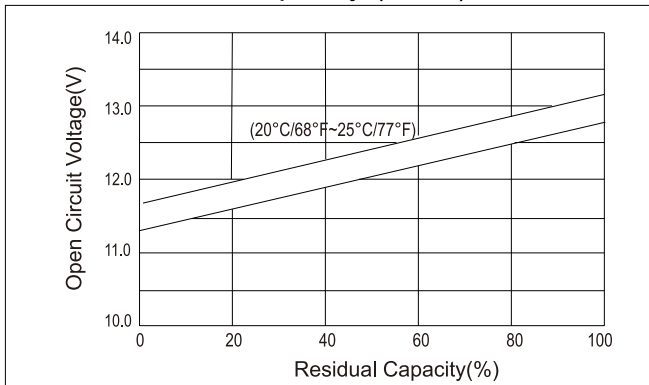

### ● The Relationship for Charging Voltage and Temperature

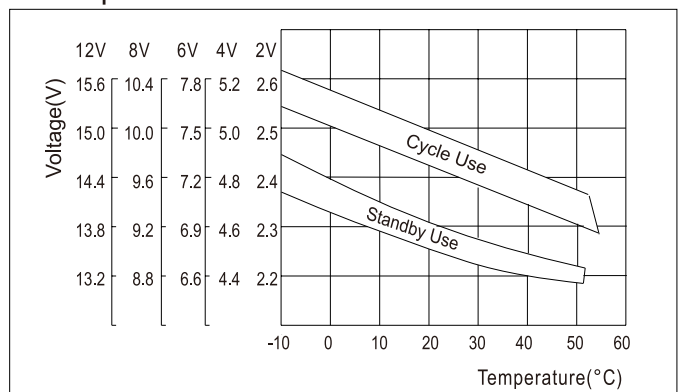

### ● Floating Life on Temperature

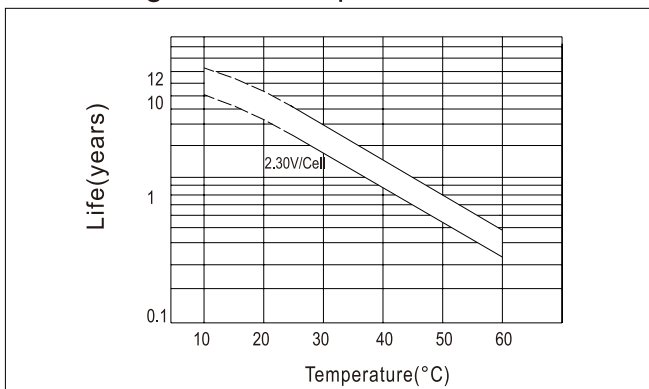

### ● Cycle Life on D.O.D (25°C)

