



● Specifications

Nominal Voltage		12V
Rated Capacity (20 hour rate)		9AH
Dimensions	Total Height	101±2mm(3.98 inches)
	Height	95±2mm(3.74 inches)
	Length	151±2mm(5.94 inches)
	Width	65 mm(2.56 inches)
Weight Approx		2.45kg(5.40lbs)± 4%

● Characteristics

Capacity 25°C(77°F)	20 hour rate(0.45A)	9.00 AH
	10 hour rate(0.85A)	8.50 AH
	5 hour rate(1.56A)	7.80AH
	1 hour rate(5.85A)	5.85 AH
Internal Resistance	Full charged Battery at 25°C(77°F)	18m Ω
Capacity affected by Temperature (20hour rate)	40°C(104°F)	102%
	25°C(77°F)	100%
	0°C(32°F)	85%
	-15°C(5°F)	65%
Self-Discharge at 25°C(77°F)	Capacity after 3 month storage	91%
	Capacity after 6 month storage	82%
	Capacity after 12 month storage	64%
Charge (constant voltage)	Cycle	Initial Charging Current Less than 2.7 A Voltage 14.50-14.90V
	Float	Voltage 13.50-13.80V

● Applications

- Electric tools
- Electric toys
- Emergency lighting
- Electronic instruments
- Medical equipment
- Alarm and security systems
- Solar power systems
- Wind power systems
- Telecommunication equipments
- Uninterruptible power supplies

● Outer Dimensions (mm)

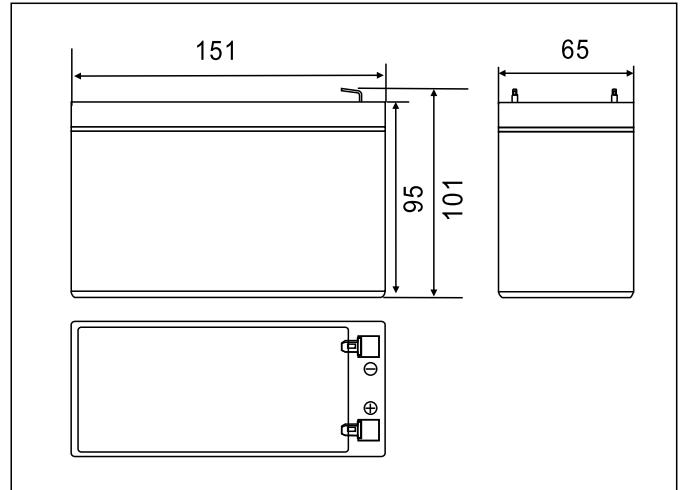

● Terminal Type (mm)

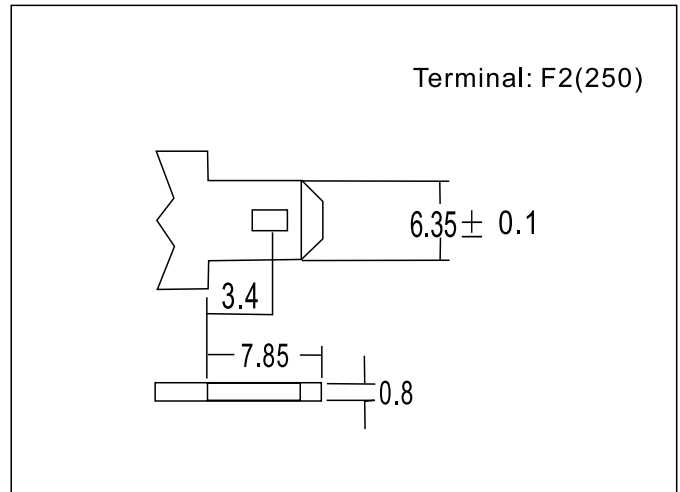

Constant Current(AMP) and Constant Power(Watt) Characteristics at 25°C(77°F)

F.V/TIME	5min	10min	15min	30min	1h	2h	3h	4h	5h	10h	20h	
9.60V	A	34.2	21.6	17.1	9.54	5.85	3.21	2.30	1.84	1.56	0.85	0.46
	w	382	244	195	109	67.7	37.4	27.3	21.9	18.6	10.2	5.48
9.90V	A	33.2	21.0	16.7	9.35	5.76	3.18	2.28	1.83	1.55	0.85	0.45
	w	370	236	190	107	66.7	37.2	27.1	21.7	18.5	10.2	5.46
10.2V	A	31.8	20.1	16.1	9.06	5.62	3.15	2.27	1.81	1.54	0.84	0.45
	w	355	227	183	104	65.0	36.9	26.9	21.6	18.4	10.1	5.43
10.5V	A	30.4	19.2	15.5	8.84	5.50	3.11	2.25	1.80	1.53	0.84	0.45
	w	340	217	177	101	63.7	36.4	26.7	21.4	18.3	10.0	5.40
10.8V	A	28.7	18.1	14.7	8.52	5.34	3.03	2.18	1.75	1.75	0.82	0.44
	w	321	205	168	97.6	61.8	35.4	25.9	20.8	20.8	9.84	5.29

● Discharge Characteristics(25°C)

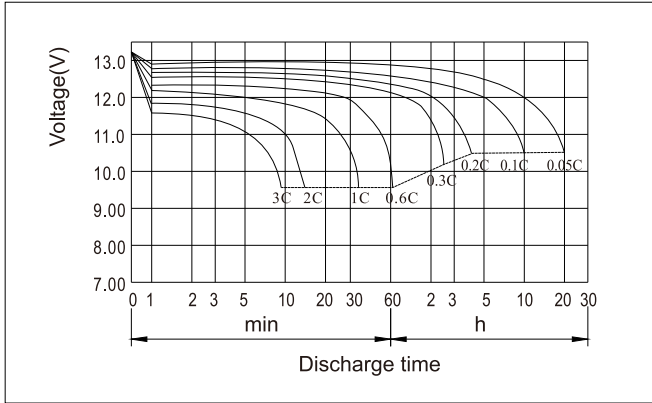

● Charging Characteristics(25°C)

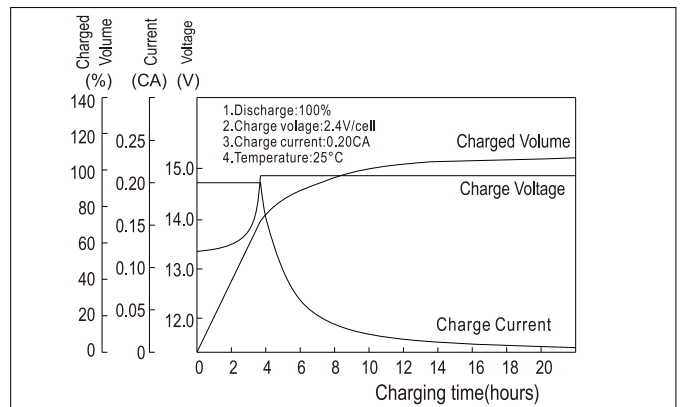

● Effect of Temperature on Capacity

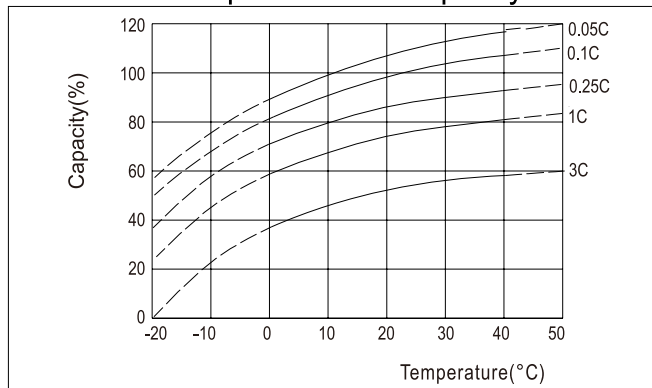

● Self-discharge Characteristics

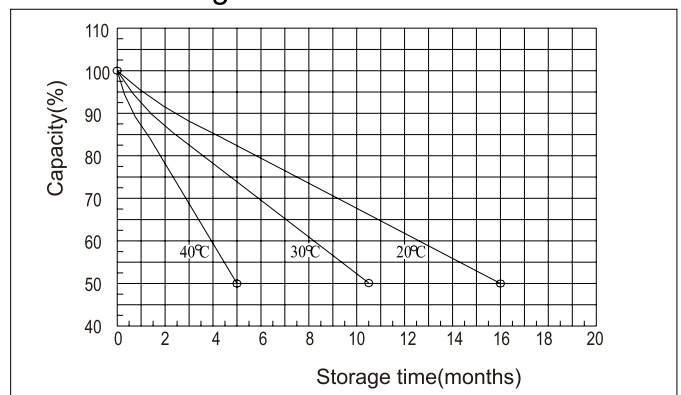

● The Relationship for Open Circuit Voltage and Residual Capacity (25°C)

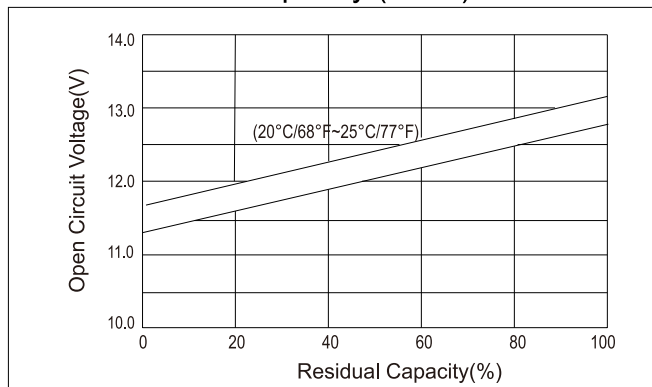

● The Relationship for Charging Voltage and Temperature

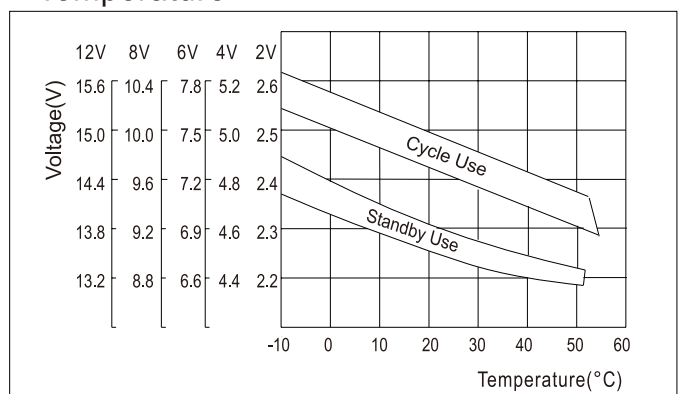

● Floating Life on Temperature

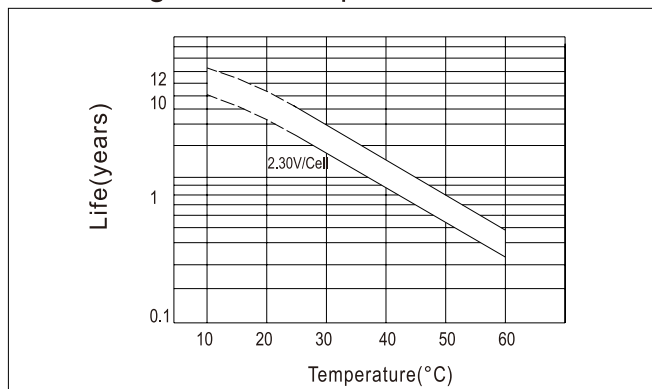

● Cycle Life on D.O.D (25°C)

